

A/F 11,0 [0,43]

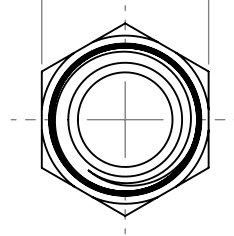

24,3 [0,96]

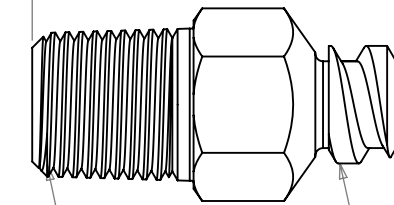

1/8" NPT MALE THREAD  
FEMALE LUER THREAD

1	WTsang	TTsang	SBurton	06/06/2017	
REV	CREATED	CHECKED	APPROVED	DWG DATE	REF

MATERIAL: STAINLESS STEEL, SILCONE, 302 STAINLESS STEEL

If dimensional information is critical, please contact Eoxshop.com for confirmation. All dimensions are in accordance with the manufacturers drawings and are subject to change without prior notice.

EOXSHOP  
TEL: +44 (0) 23 9226 6031  
WWW.EOXSHOP.COM  
SALES@EOXSHOP.COM



TITLE: FEMALE LUER THREAD TO 1/8" NPT MALE THREAD VALVED CONNECTOR, STAINLESS STEEL

	DIM'S mm[inch]	SCALE NTS	SIZE A4	SHEET 1 / 1	DOCUMENT NUMBER E-F-171427	REVISION 1
--	-------------------	--------------	------------	----------------	-------------------------------	---------------